

Light efficiency:

41 Lumen/Watt

Light quality:

CRI: 56.6

Color temperature:

4144 K

Output: 8694 lm

Peak: 409595 cd

Power: 213 W

PF: 1.0



Product name:

Hydro Flex L7 (Zoom In Lime)

Item number:

Date and time:

8/25/2025 9:00:50 AM

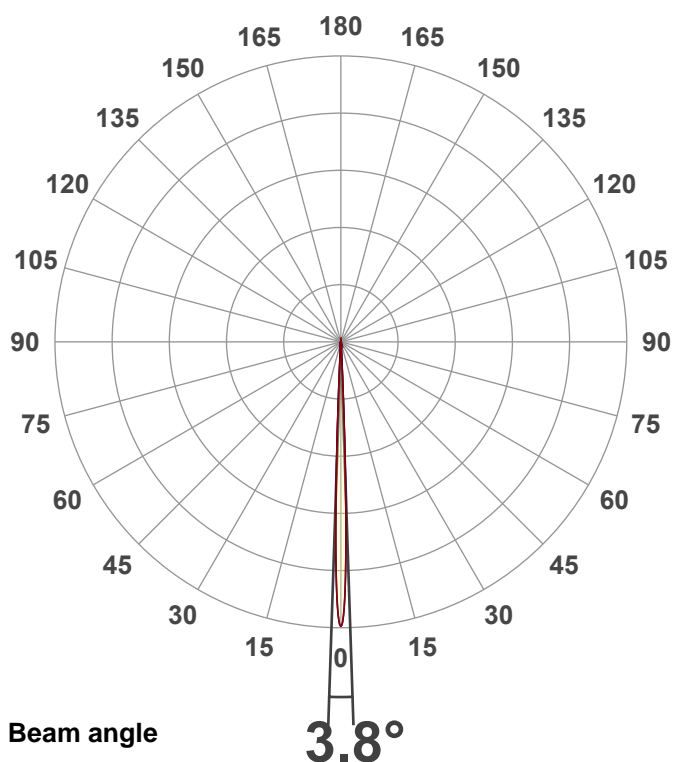

CIE 1931
x: 0.410
y: 0.518

Spectra

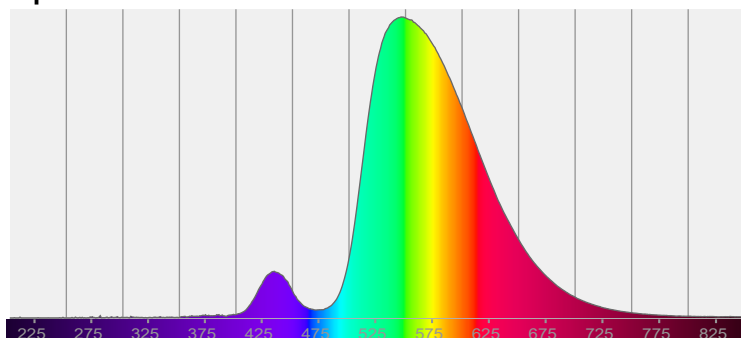

Power

Voltage: 117 V
Current: 1.82 A
Frequency: 0 Hz

Color details

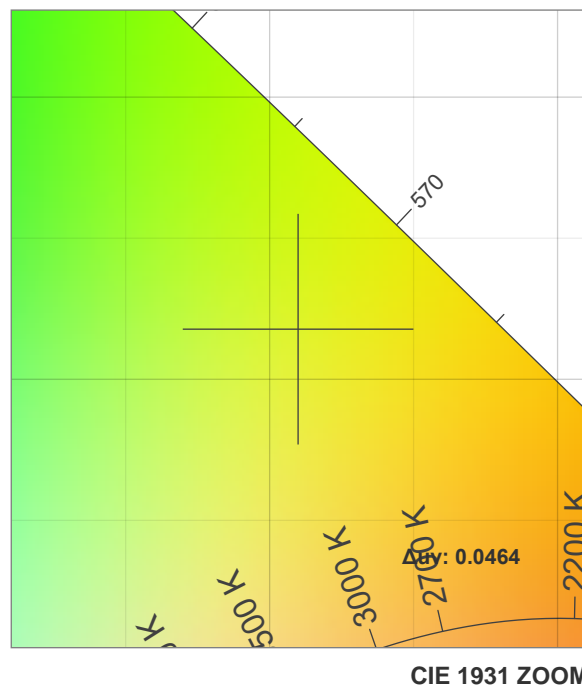
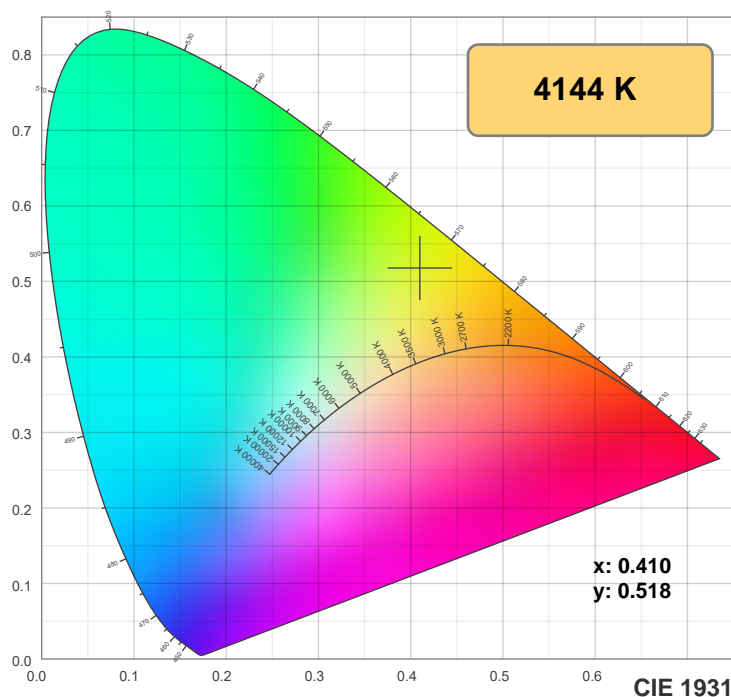

TM-30: 0.0

CRI: 56.6 (R1-R8)

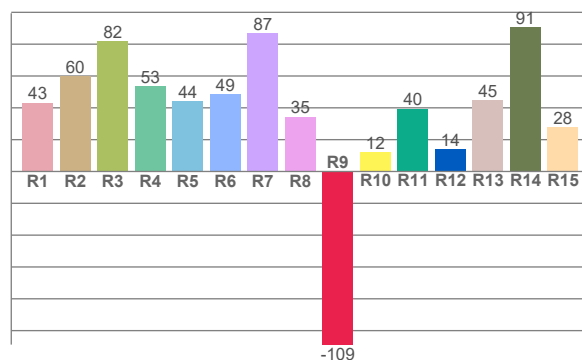
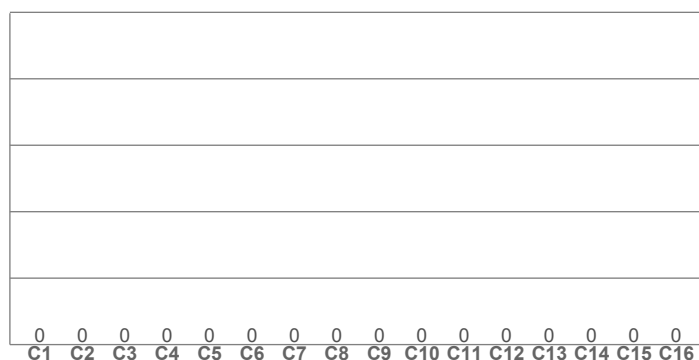

CRI R values, only R1-R8 are used to calculate final CRI value

R1	R2	R3	R4	R5	R6	R7	R8	R9	R10	R11	R12	R13	R14	R15
43.3	59.8	82.0	53.4	44.2	48.6	87.0	34.5	-108.8	12.2	39.6	13.9	45.0	90.8	27.8

TM30 C values, 16 binned values out of total of 99 C values

C1	C2	C3	C4	C5	C6	C7	C8	C9	C10	C11	C12	C13	C14	C15	C16
0.0	0.0	0.0	0.0	0.0	0.0	0.0	0.0	0.0	0.0	0.0	0.0	0.0	0.0	0.0	0.0

CQS Q values

Q1	Q2	Q3	Q4	Q5	Q6	Q7	Q8	Q9	Q10	Q11	Q12	Q13	Q14	Q15
63.3	84.3	75.2	67.5	62.9	56.1	47.6	47.1	42.0	19.8	28.9	41.5	52.7	33.5	48.5

CQS: 48.3

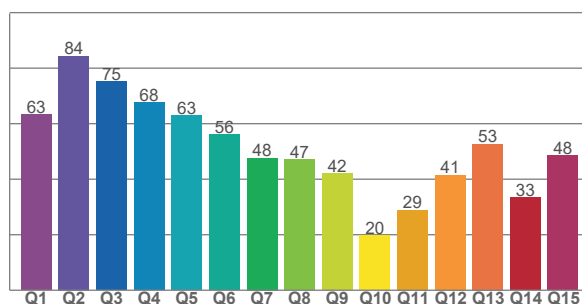

Color parameters

Color temperature	Color rendering index	Red component	Color fidelity	Color gamut	Color quality scale	Color coordinate cie 1931	Color coordinate cie 1931	Color coordinate	Color coordinate	Color deviation from black body
CCT	CRI	CRI R9	TM30 Rf	TM30 Rg	CQS	x	y	u	v	Δuv
4144 K	56.6	-108.8	0.0	n/a	48.3	0.410	0.518	0.195	0.370	0.0464

TM-30 details

Rf 0.0

Fidelity index Rf

Rg n/a

Gamut index Rg

Hue Bin	R _i	Shifts (%)	
		Chroma	Hue
1	0	0%	0%
2	0	0%	0%
3	0	0%	0%
4	0	0%	0%
5	0	0%	0%
6	0	0%	0%
7	0	0%	0%
8	0	0%	0%
9	0	0%	0%
10	0	0%	0%
11	0	0%	0%
12	0	0%	0%
13	0	0%	0%
14	0	0%	0%
15	0	0%	0%
16	0	0%	0%

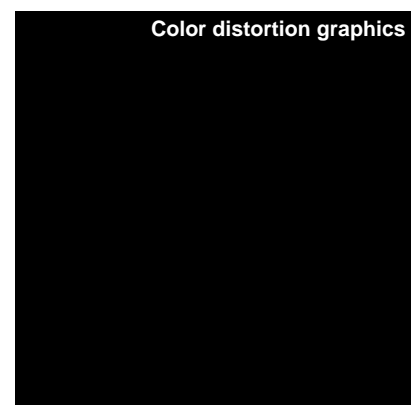
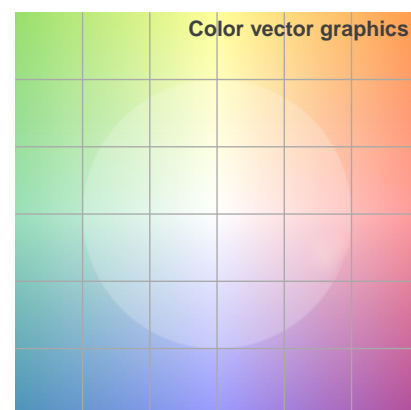
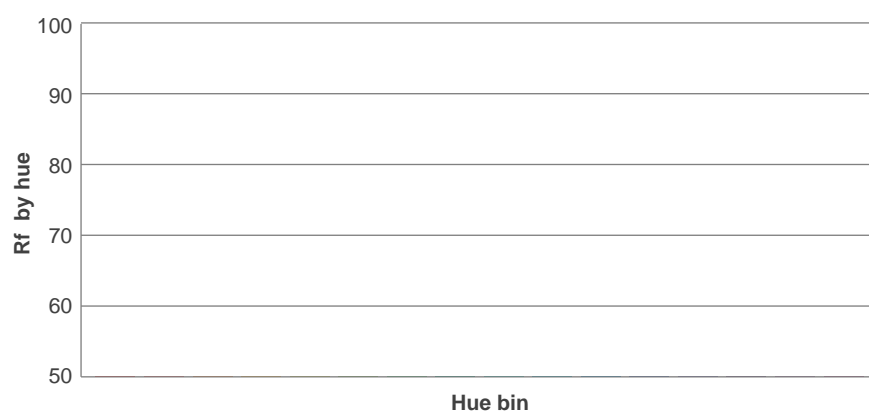

Color Evaluation Sample

Beam details

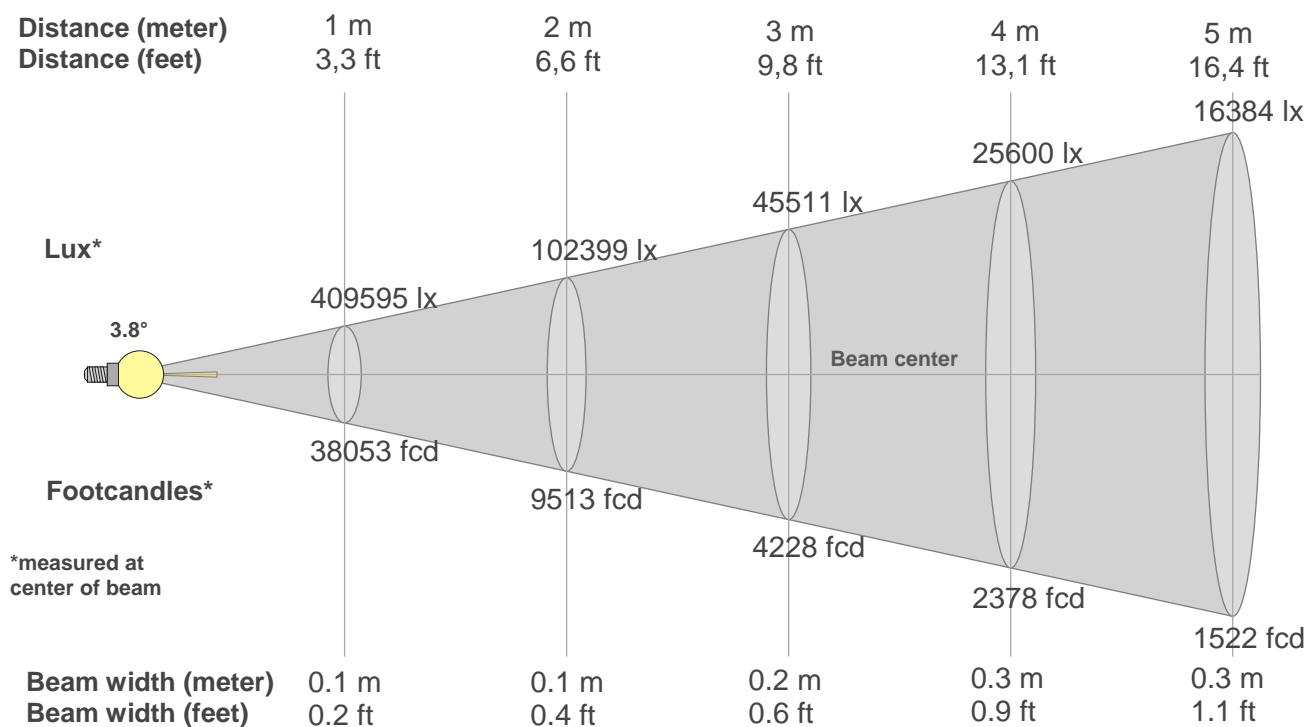

Beam intensities from 1-20m

1m	2m	3m	4m	5m	6m	7m	8m	9m	10m	11m	12m	13m	14m	15m	16m	17m	18m	19m	20m
3.3ft	6.6ft	9.8ft	13.1ft	16.4ft	19.7ft	23ft	26.2ft	29.5ft	32.8ft	36.1ft	39.4ft	42.7ft	45.9ft	49.2ft	52.5ft	55.8ft	59.1ft	62.3ft	65.6ft
409595lx	102399lx	45511lx	25600lx	16384lx	11378lx	8359lx	6400lx	5057lx	4096lx	3385lx	2844lx	2424lx	2090lx	1820lx	1600lx	1417lx	1264lx	1135lx	1024lx
38052.6 fcd	9513.1 fcd	4228.1 fcd	2378.3 fcd	1522.1 fcd	1057 fcd	776.6 fcd	594.6 fcd	469.8 fcd	380.5 fcd	314.5 fcd	264.3 fcd	225.2 fcd	194.1 fcd	169.1 fcd	148.6 fcd	131.7 fcd	117.4 fcd	105.4 fcd	95.1 fcd

Intensities in 0° c-plane

0°	1°	2°	3°	4°	5°	6°	7°	8°	9°	10°	11°	12°	13°	14°	15°	16°	17°	18°	19°
410k	354k	181k	30k	2k	1k	1k	1k	1k	1k	1k	1k	1k	1k	1k	1k	1k	1k	1k	1k
100%	86%	44%	7%	0%	0%	0%	0%	0%	0%	0%	0%	0%	0%	0%	0%	0%	0%	0%	0%

Intensities in 90° c-plane

0°	1°	2°	3°	4°	5°	6°	7°	8°	9°	10°	11°	12°	13°	14°	15°	16°	17°	18°	19°
410k	354k	181k	30k	2k	1k	1k	1k	1k	1k	1k	1k	1k	1k	1k	1k	1k	1k	1k	1k
100%	86%	44%	7%	0%	0%	0%	0%	0%	0%	0%	0%	0%	0%	0%	0%	0%	0%	0%	0%

Intensities in 180° c-plane

0°	1°	2°	3°	4°	5°	6°	7°	8°	9°	10°	11°	12°	13°	14°	15°	16°	17°	18°	19°
410k	354k	181k	30k	2k	1k	1k	1k	1k	1k	1k	1k	1k	1k	1k	1k	1k	1k	1k	1k
100%	86%	44%	7%	0%	0%	0%	0%	0%	0%	0%	0%	0%	0%	0%	0%	0%	0%	0%	0%

Intensities in 270° c-plane

0°	1°	2°	3°	4°	5°	6°	7°	8°	9°	10°	11°	12°	13°	14°	15°	16°	17°	18°	19°
410k	354k	181k	30k	2k	1k	1k	1k	1k	1k	1k	1k	1k	1k	1k	1k	1k	1k	1k	1k
100%	86%	44%	7%	0%	0%	0%	0%	0%	0%	0%	0%	0%	0%	0%	0%	0%	0%	0%	0%

Beam angle 50%	Field angle 10%	Cutoff angle 2,5%	Intensity ratio in 120° cone	Intensity ratio in 90° cone
3.8°	5.7°	6.8°	40.0%	31.5%

Flicker curve (complete sampled flicker signal)



Flicker frame (frame of one flicker period)

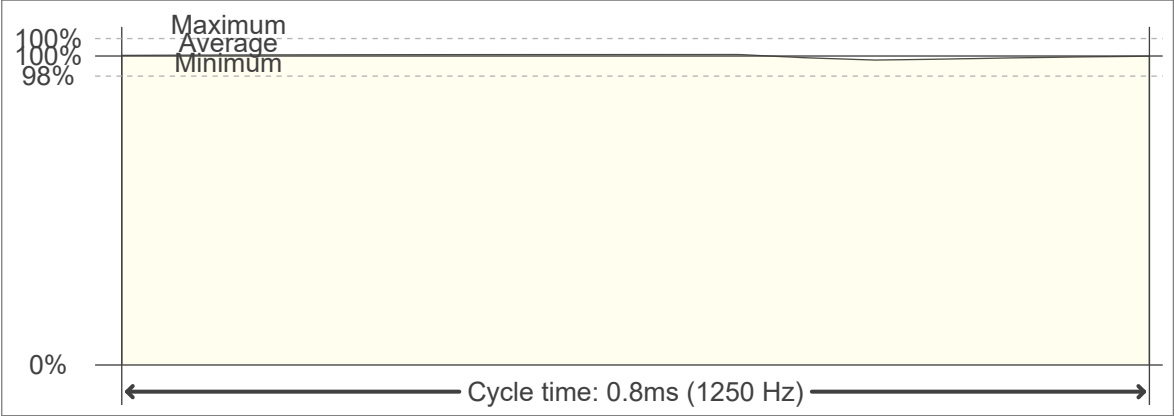

Flicker FFT (frequency scope of flicker curve)

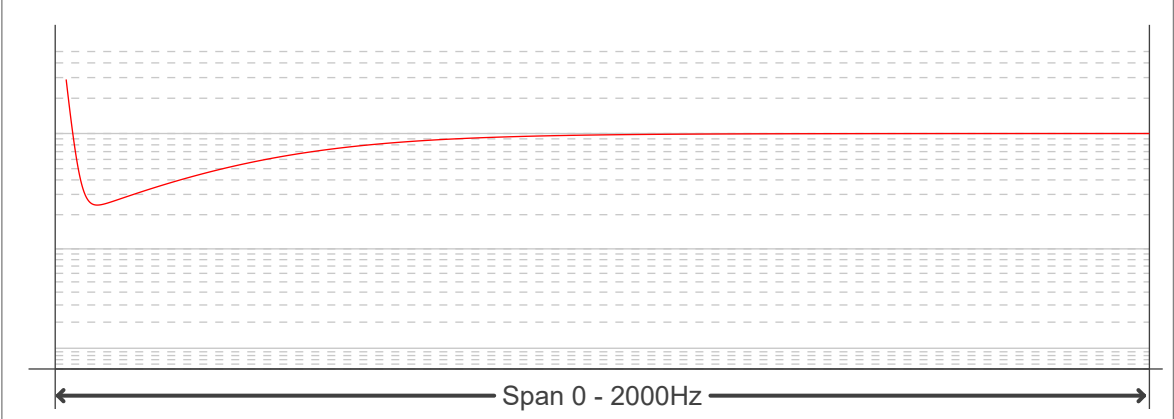

Flicker results:

Flicker frequency:		1250 Hz	
Flicker index:	0	JA8/10 40Hz	0.21 %
Flicker percentage:	1.15 %	JA8/10 90Hz	0.23 %
SVM: (Visual flicker)	0.01	JA8/10 200Hz	0.23 %
PstLM	0	JA8/10 400Hz	0.24 %
Mp	0.17	JA8/10 1000Hz	0.26 %

Flicker conditions:

Sample rate:	20000 samples/second
--------------	----------------------